

# HELIDECK INFORMATION PLATE

**Semi Sub**

**Deepsea Stavanger**

**XSTV**

## GENERAL INFORMATION:

<b>OPERATOR</b>	<b>HIP ISSUE DATE</b>	<b>HLAC EXPIRY DATE</b>
Odfjell Drilling (UK) Ltd	27 Feb 2025	26 May 2025
<b>HELIDECK ELEVATION</b>	<b>INSTALATION HEIGHT</b>	<b>POSITION</b>
116ft	349ft	Mobile
<b>MAX WEIGHT</b>	<b>D VALUE</b>	<b>VAR</b>
13t	20.88m	Check
<b>TD/PM &amp; H LIGHTING</b>	<b>PITCH / ROLL / HEAVE CATEGORY</b>	<b>HIGHEST OBSTACLE</b>
No	Cat 1.	Within 5nm: Check

## NORWAY SPECIFIC INFORMATION:

<b>YEAR KEEL LAID</b>	<b>SAFE LANDING AREA</b>	<b>Dh</b>
2009	26.1m	20.88m

## COMMUNICATIONS:

## TURNAROUND:

<b>VHF FREQUENCIES</b>	<b>NDB</b>	<b>FUELING</b>	<b>STARTING</b>
Traffic: Check    Logistics: Check	544Khz    Ident: DSS	Yes	Yes

## LIMITATION / COMMENTS:

### TEMPORARY LIMITATION NOTICES

Nil

LIMITATIONS	WIND DIRECTION (T°)	WIND SPEED (Kts)
No operations UKCS - No HERTL / No aeronautical Radio		
Table 1(T) if overflight of 5:1 infringements unavoidable		
Relative to helideck heading (hdg) All types – Table 2 (L&T) –	155-230	25-35kts
Relative to helideck heading (hdg) No landings.	155-230	>35kts
Helideck aiming circle offset and H swung 15°		
Infringement 150°sector marked with obstruction colours.		
HMS rev 9.2NO with red flashing repeater lights fitted.		
Daylight operations only - UK Waters and UK reg Aircraft		
Stable deck conditions - UK Waters and UK reg Aircraft.		

### COMMENTS

Nil

## NON-COMPLIANCES:

<b>210°</b>	<b>150°</b>
GPS Antennas on railing at fwd access platform approximately 200mm	Bridge structure 6.2m from SLA, 3,25m ADL -
Multiple heat trace cable joints / black plastic tubes approximately	

**NON-COMPLIANCES:**

<b>5:1</b>	<b>Misc</b>
Forward access platform extends 3.5m from SLA	No valid friction test -30kts wind limitation UKCS.
Port flare boom may infringe sector when extended.	

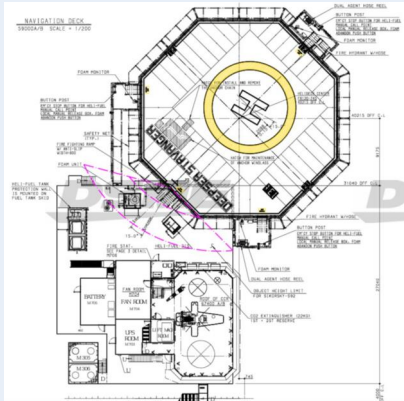
**IMAGE LIBRARY:****PLAN DRAWING****ADDITIONAL (IF AVAILABLE)****PORT SIDE****STARBOARD SIDE**